

This document contains proprietary information and such information may not be disclosed to others for any purposes, not used for sales/marketing/procurement purposes without written permission

REV	DESCRIPTION OF REVISION	Date	Approved
A	Initial Release	2017/12/8	2017/12/8

- 1. Electrical
  - 1.1 Frequency: 0-40G
  - 1.2 Impedance: 50 Ohm
  - 1.3 VSWR:1.3

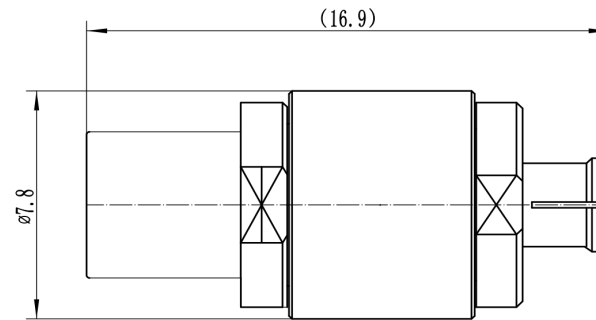

- 2. Material& Finish
  - 2.1 Inner Contact: Beryllium bronze, gold plated
  - 2.2 Outer Contact: Beryllium bronze, gold plated/stainless steel
  - 2.3 Insulators: PEI

Notes:

- 1. ALL SPECIFICATIONS ARE SUBJECT TO CHANGE NOTICE AT ANY TIME
- 2.CUSTOMER OUTLINE DRAWING FOR REFERENCE ONLY

<b>Xi'an Reach-line Technology Co., Limited</b>
Description: SMP male to female adapter
Part No.: RL-SMP-JK
DIMENSION IN MILLIMETERS(mm)